

Quick Start Guide: For Processing Plasma from 120mL Whole Blood

PLEASE REFER TO THE IFU FOR A 120mL PRP PROCESSING AND OBTAIN ~60mL PPP.



Step 1
Set the air filter assembly yellow stopcock to this orientation.



Step 2
Remove the red caps and attach the air filter assembly.



Step 3
Remove the blue cap, opposite the air filter assembly and attach the PPP syringe.

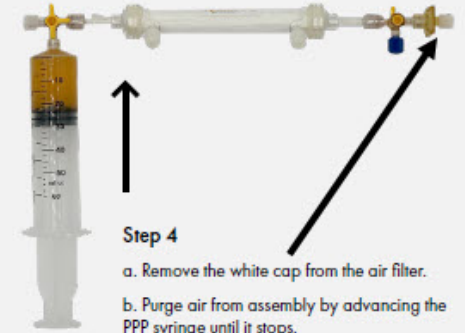

Step 4
a. Remove the white cap from the air filter.
b. Purge air from assembly by advancing the PPP syringe until it stops.
c. Re-cap the air filter.

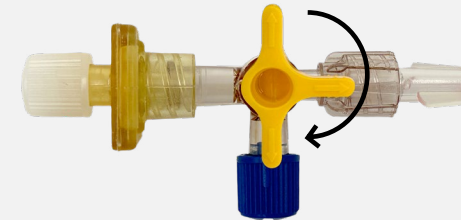

Step 5
Flip the assembly and reset stopcock orientation as shown.

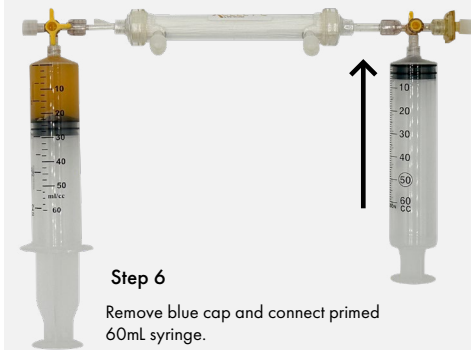

Step 6
Remove blue cap and connect primed 60mL syringe.

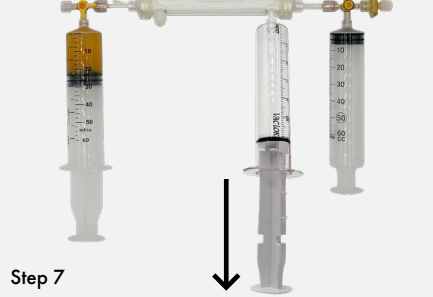

Step 7
Remove one of the white caps on the bottom of the filter, connect Vaclok syringe, and draw back to 60mL.

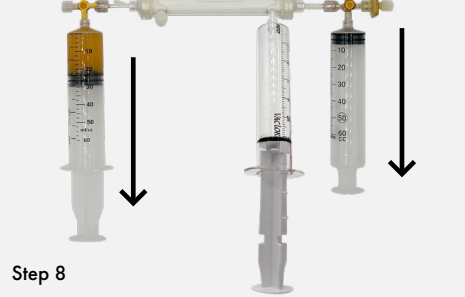

Step 8
Hold both 60mL syringe and tangentially process using a table or bench.



Step 9
Transfer plasma back and forth between syringes @5mL/1sec rate until about 4mL remains. Observe abundant water in the Vaclok.

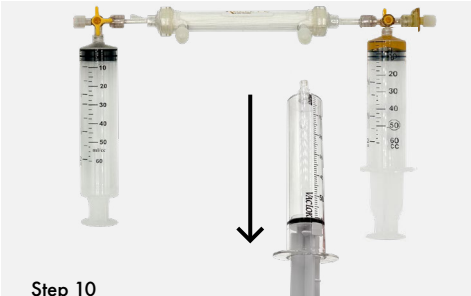

Step 10
Remove the Vaclok syringe and re-cap the port.



Step 11
a. Compress the air filter-side syringe, close the stopcock.
b. Remove the air filter cap.



Step 12
Aspirate ~8mL protein concentrate by drawing back the opposite syringe. Turn the stopcock to seal the port, remove and cap the syringe.