

# Quick Start Guide: For Processing Plasma from 60mL Whole Blood

PLEASE REFER TO THE IFU FOR A 60mL PRP PROCESSING AND OBTAIN ~30mL PPP.



**Step 1**  
Set the air filter assembly yellow stopcock to this orientation.



**Step 2**  
Remove the red caps and attach the air filter assembly.



**Step 3**  
Remove the blue cap, opposite the air filter assembly and attach the PPP syringe.

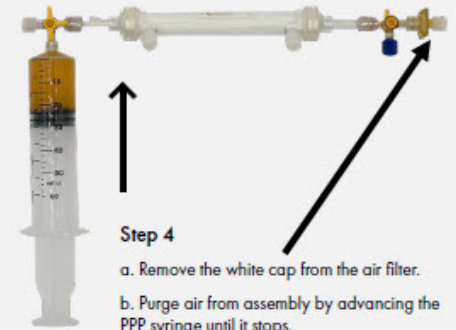

**Step 4**  
a. Remove the white cap from the air filter.  
b. Purge air from assembly by advancing the PPP syringe until it stops.  
c. Re-cap the air filter.

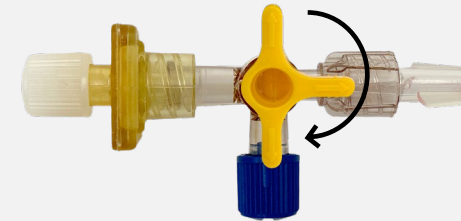

**Step 5**  
Flip the assembly and reset stopcock orientation as shown.

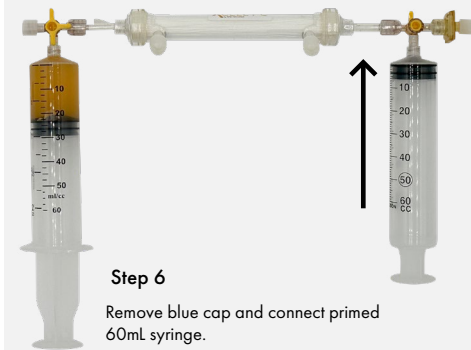

**Step 6**  
Remove blue cap and connect primed 60mL syringe.

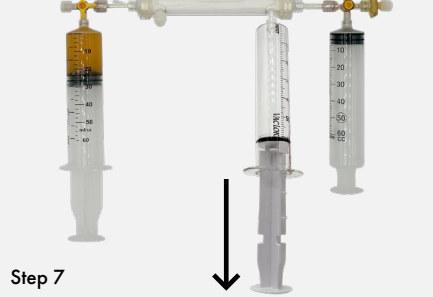

**Step 7**  
Remove one of the white caps on the bottom of the filter, connect Vaclok syringe, and draw back to 60mL.

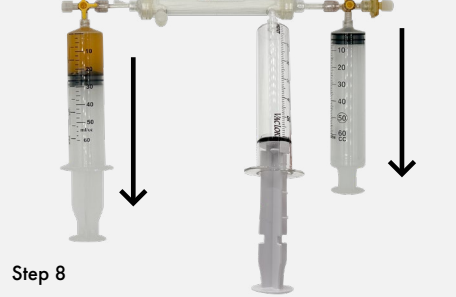

**Step 8**  
Hold both 60mL syringe and tangentially process using a table or bench.



**Step 9**  
Transfer plasma back and forth between syringes @5mL/1sec rate until plasma is gone. Observe abundant water in the Vaclok.

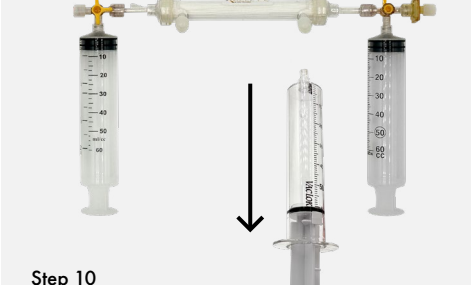

**Step 10**  
Remove the Vaclok syringe and re-cap the port.



**Step 11**  
a. Compress the air filter-side syringe, close the stopcock.  
b. Remove the air filter cap.



**Step 12**  
Aspirate 4mL protein concentrate by drawing back the opposite syringe. Turn the stopcock to seal the port, remove and cap the syringe.